

## LEGENDA

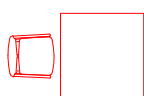

Postazione candidato

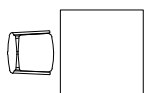

Postazione commissione esaminatrice



Postazione ingresso/identificazione candidati



Postazione gel igienizzante



Uscita di sicurezza

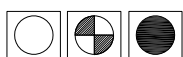

Cestini rifiuti carta/plastica/indifferenziata



Percorso deflusso candidati



Percorso ingresso candidati

# CANTIERE COMUNALE - Str. S. LUCIA n. 2

## Aula Concorso "OFFICINA MECCANICA"

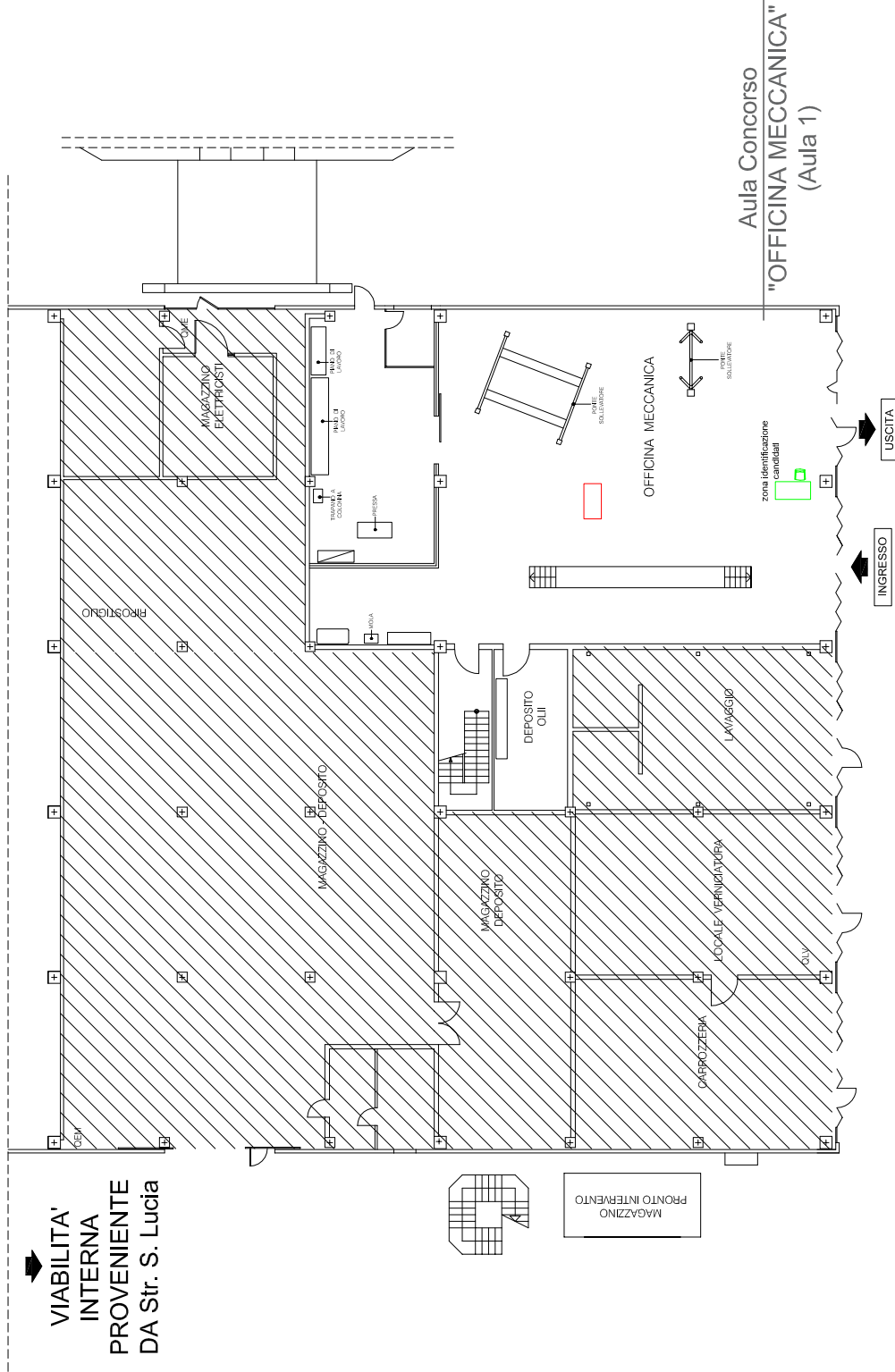

PIANO TERRA

Area Parcheggio P1

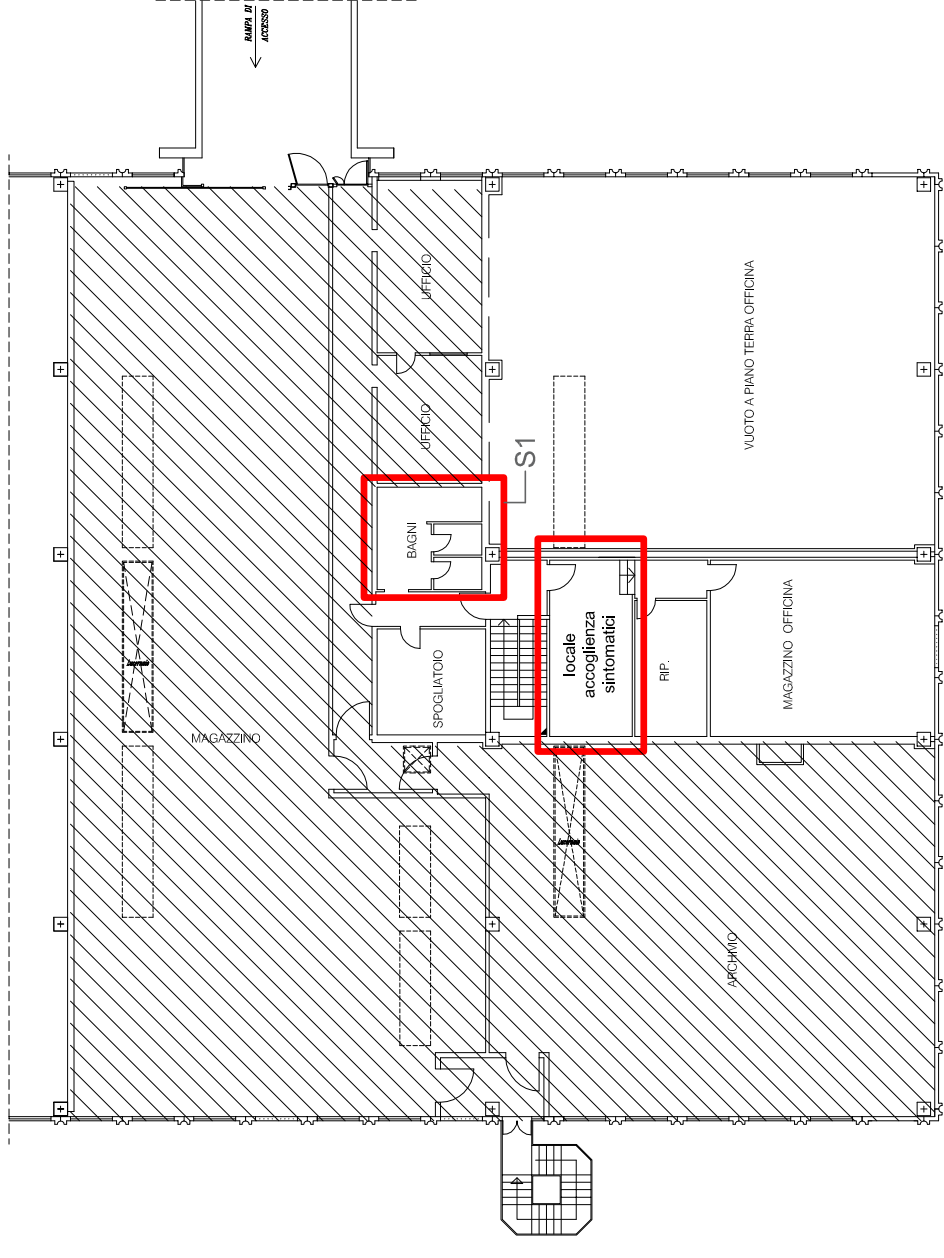

PIANO PRIMO